

For leasing information, call or email Anthony Nanni at:  
(215) 915-9967 • Anthony.Nanni@foxroach.com

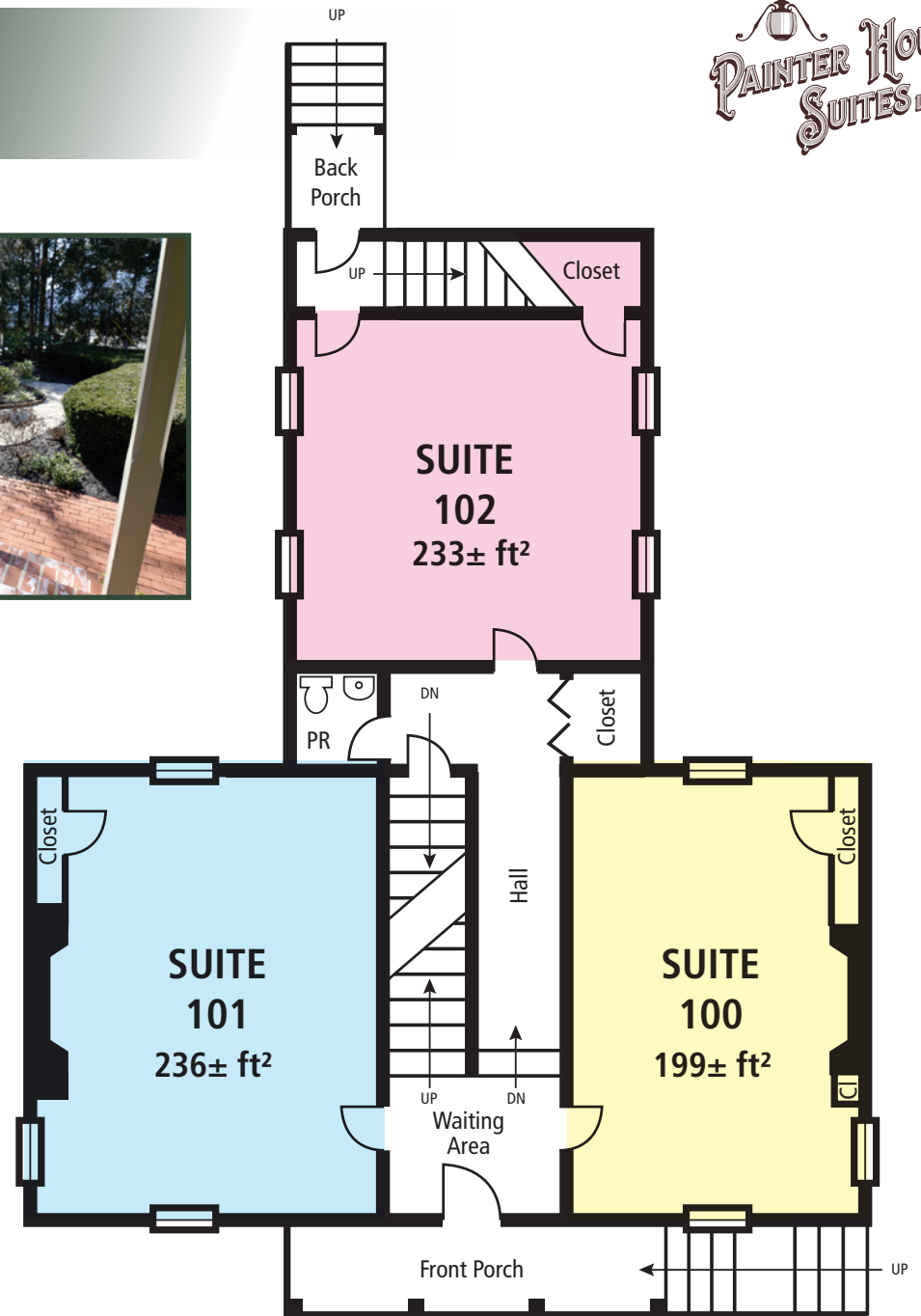

a Painter House Suites, LLC property

**FIRST FLOOR**

For leasing information, call or email Anthony Nanni at:  
(215) 915-9967 • Anthony.Nanni@foxroach.com

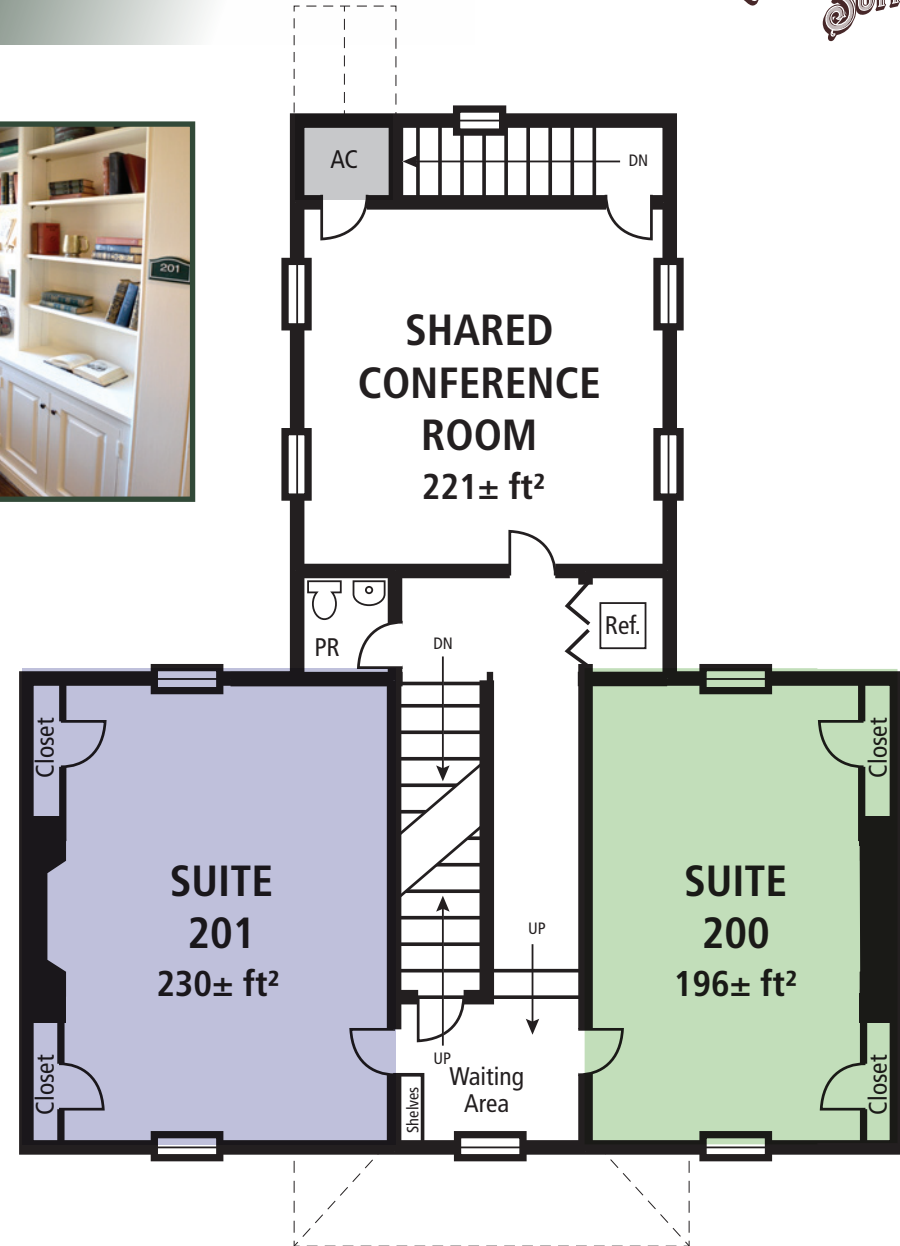

a Painter House Suites, LLC property

**SECOND FLOOR**

For leasing information, call or email Anthony Nanni at:  
(215) 915-9967 • Anthony.Nanni@foxroach.com



## Additional Property Information:

- Zoned TC (Town Center District) by West Chester Borough. Tenant's profession/business service must comply with all Borough zoning ordinances.
- Built 1818 by Nathan Sharples.
- Leases are full service. Rent includes: all utilities, property taxes, property insurance, grounds maintenance, trash/recycling, snow removal, and common area cleaning. (excludes phone and internet services).
- Every tenant receives an equal-size road side sign position.  
If a tenant rents multiple suites, they are eligible to combine each suite's sign allotment into one, larger sign.
- Free parking (5 spaces). Spaces are first come, first serve.
- Each suite includes a secured mailbox and office door mounted drop box.
- The Conference Room includes: 60" flat screen TV, Miracast, Apple TV, and complimentary Wi-Fi/Conference Telephone.
- The Conference Room is available to all tenants at no additional fee.  
Non-tenants can rent the space for: \$45/hour, \$100/half-day, and \$200/day.
- *Brickman's Corner Offices* is located on the southwest corner of High Street & Union Street, approximately 1,000 feet south of Market Street in West Chester.
- Discounts available for multi-suite lease signing. Call for details.

